

# Technical Data: Lakewood

External Dimensions of Logs (B x T): 1050 x 595 cm External Wall  
Dimension: 1030 x 575 cm  
Log thickness: 70 mm

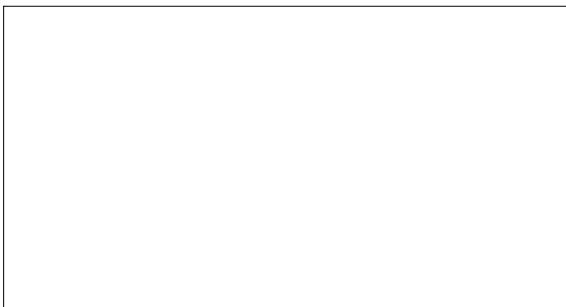

Achtung : Alle angegebenen Maße sind ca. - Maße !

# Cadiz 70 mm / 1050 x 595 cm - Fundamentplan

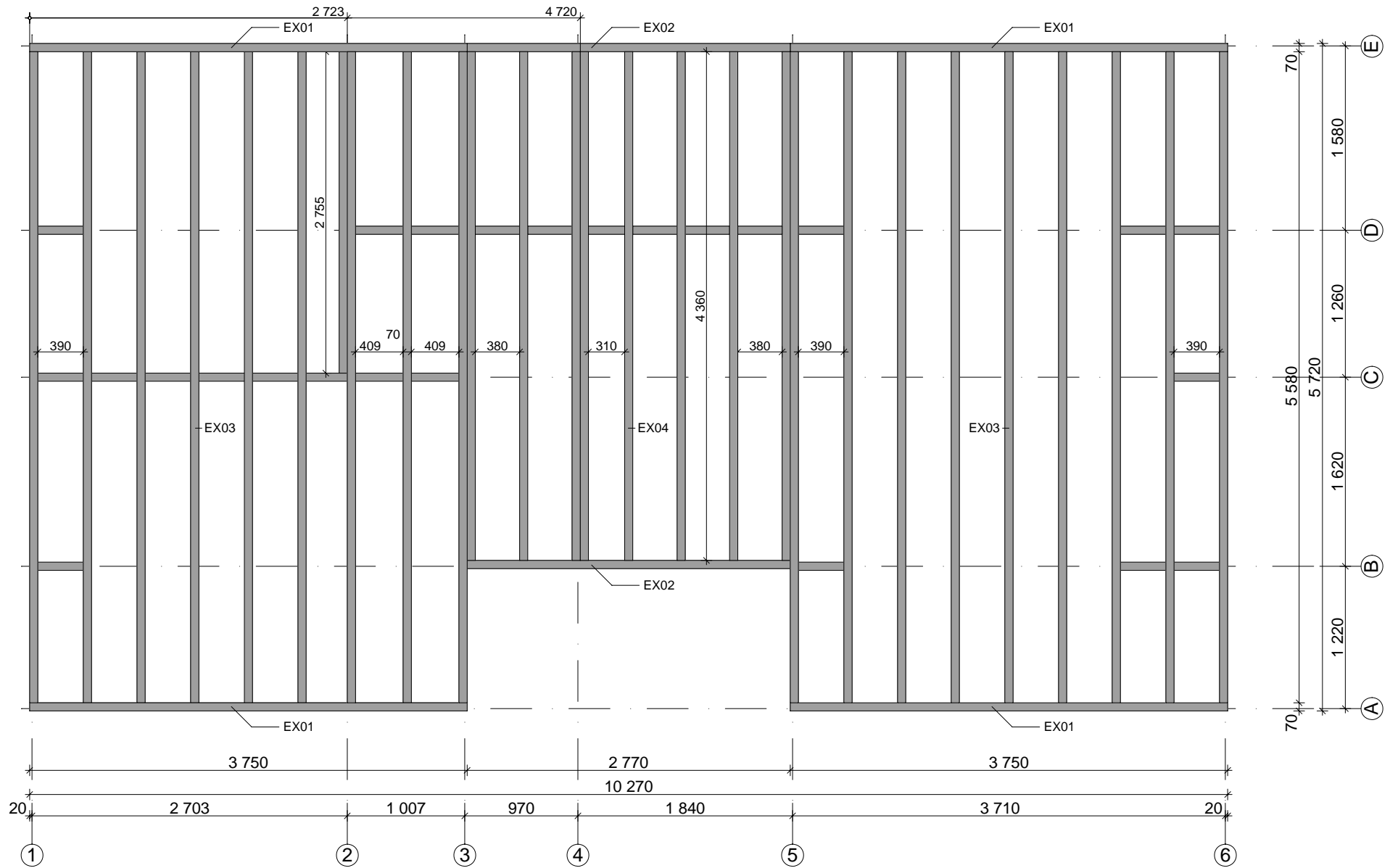

# Cadiz 70 mm / 1050 x 595 cm - Wandplan I

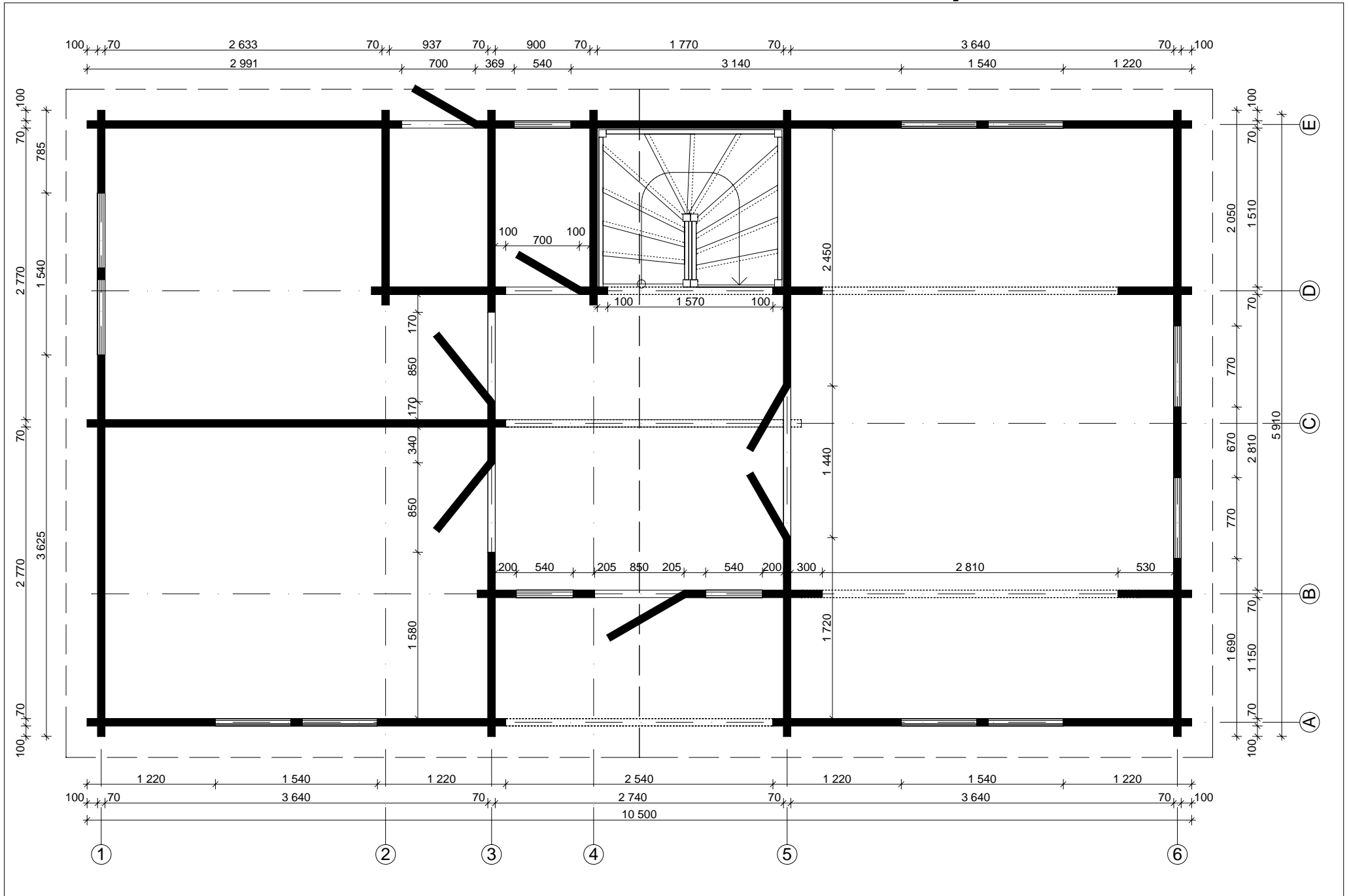

# Cadiz 70 mm / 1050 x 595 cm - Wandplan II

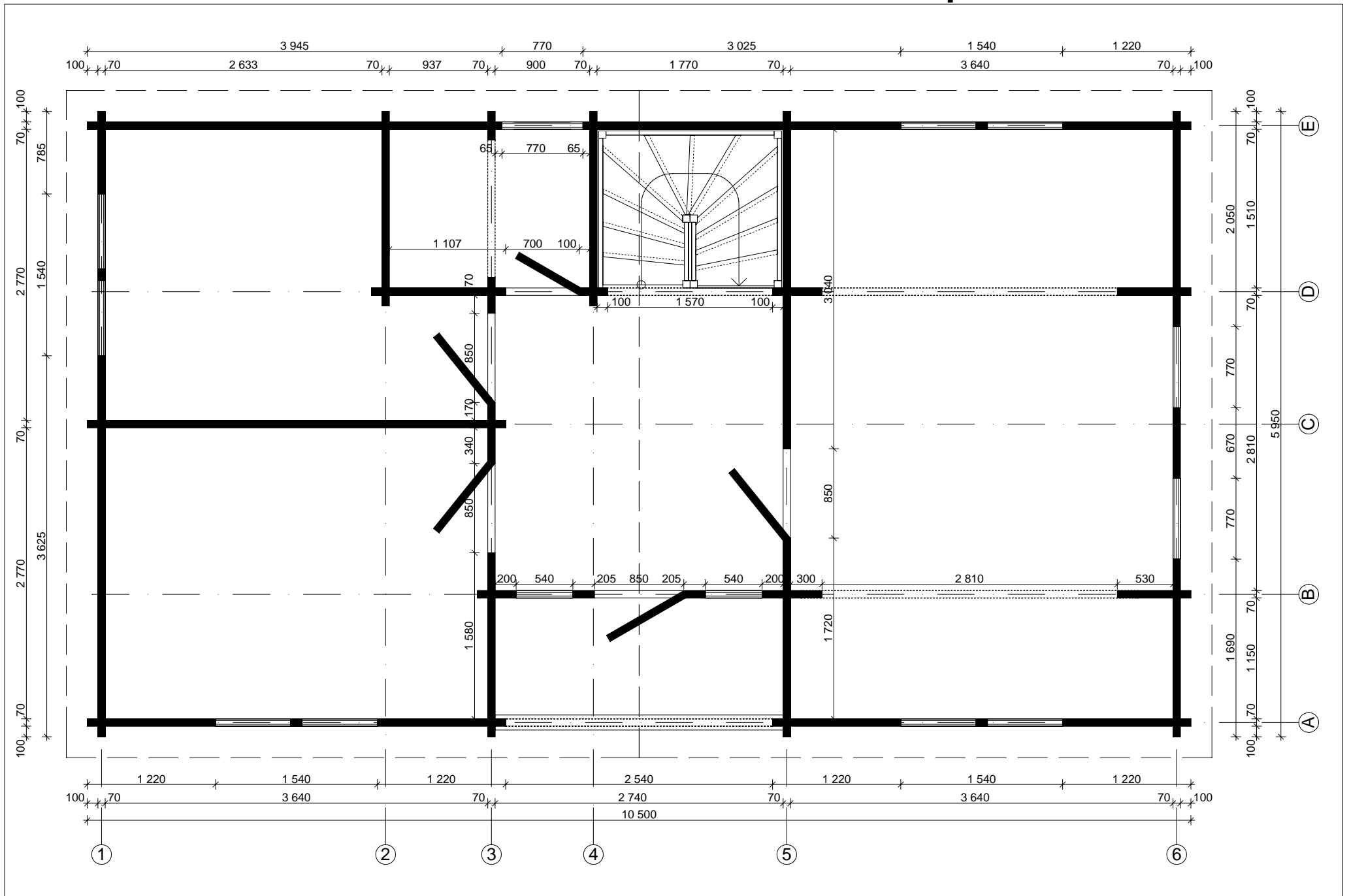

# Cadiz 70 mm / 1050 x 595 cm - Fussboden I

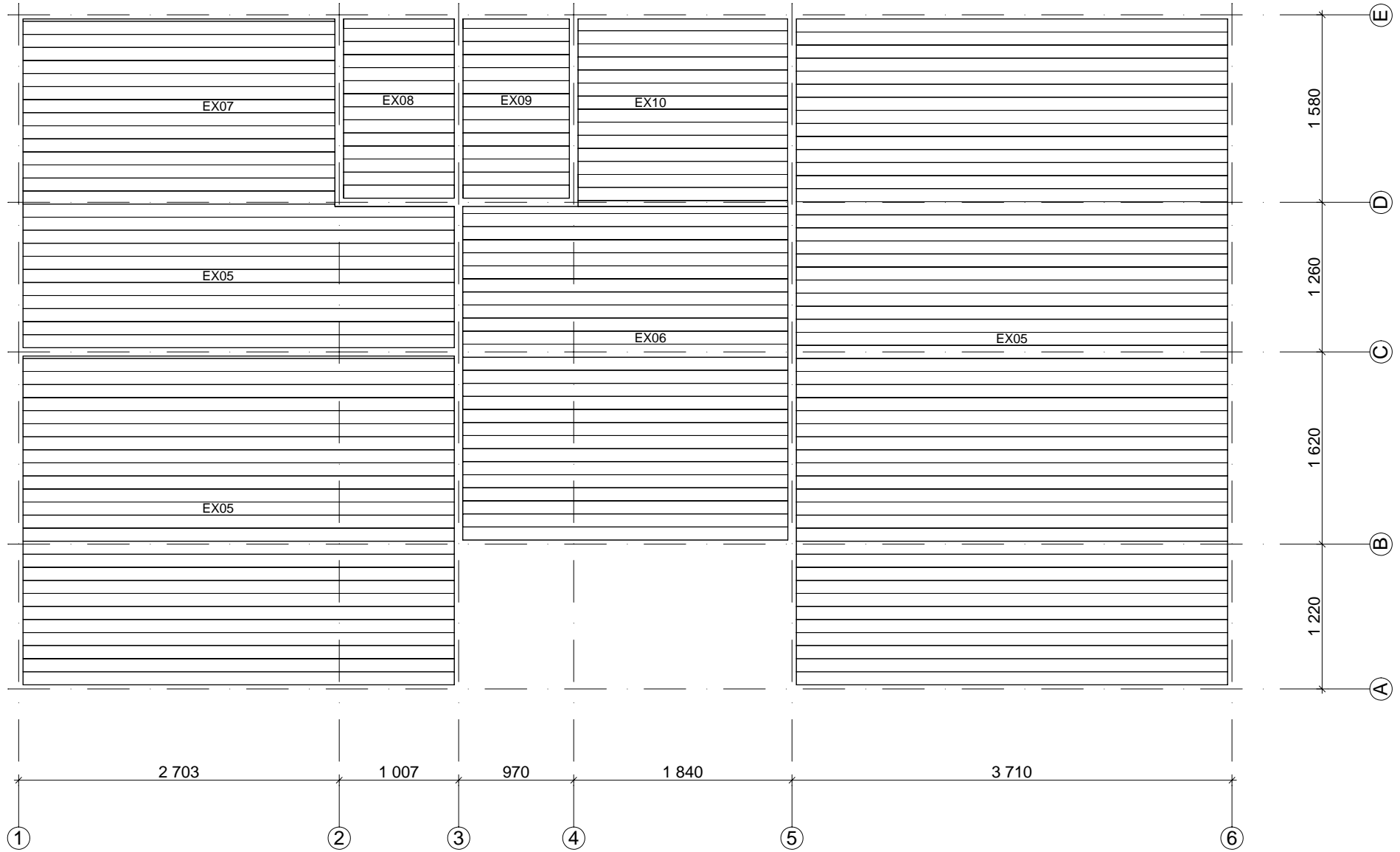

# Cadiz 70 mm / 1050 x 595 cm - Fussboden II

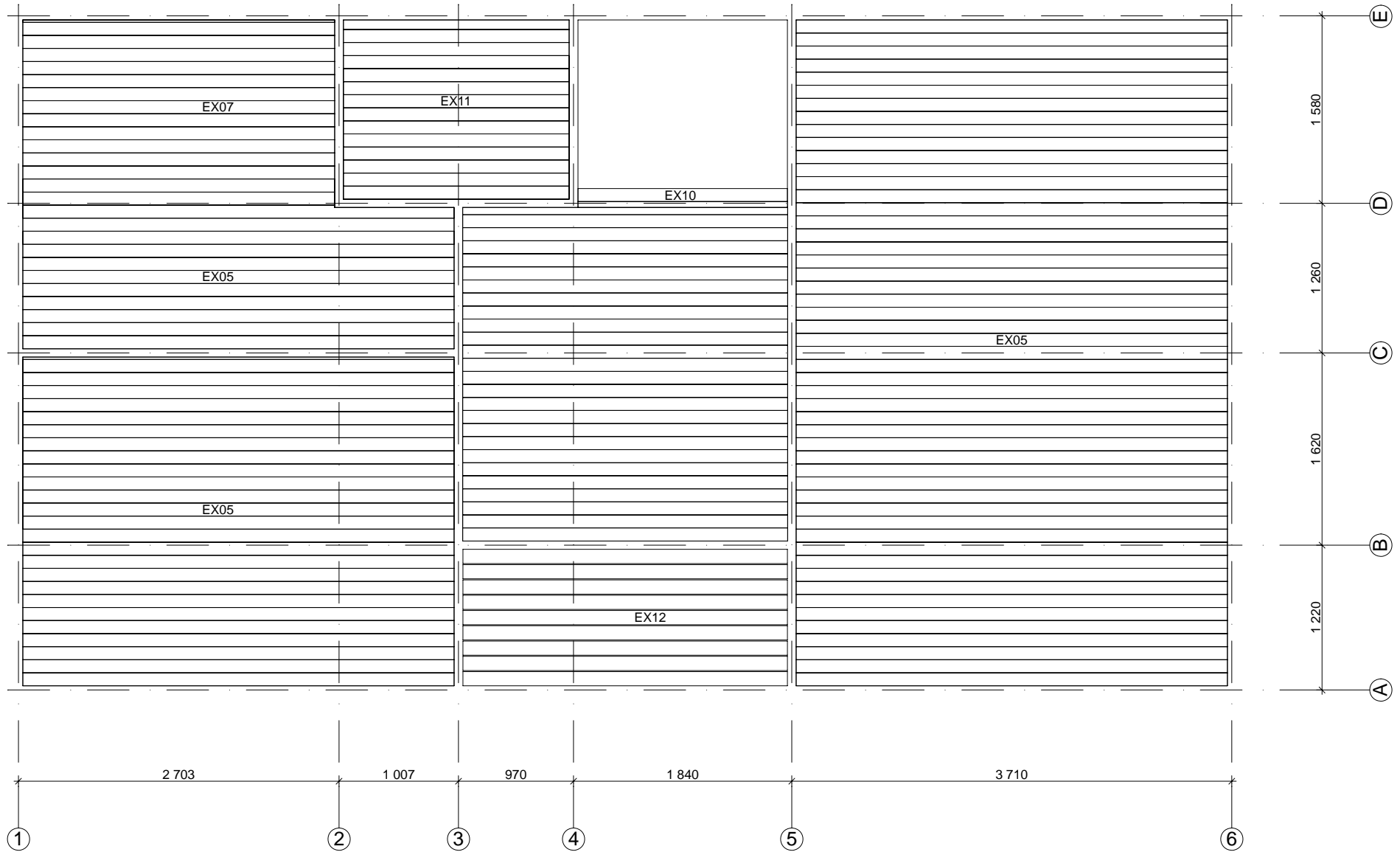

# Cadiz 70 mm / 1050 x 595 cm - Zwischenbalken

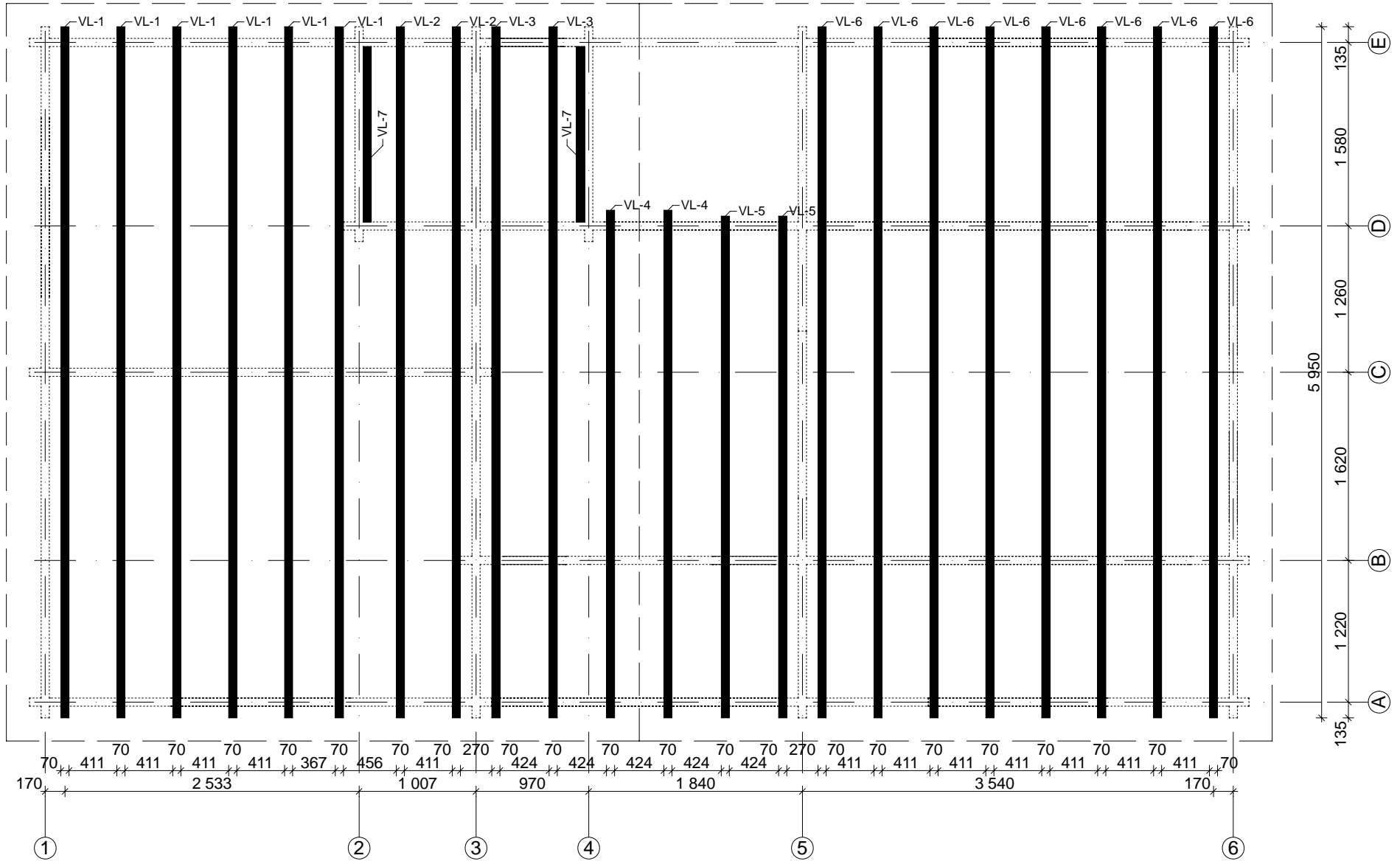

# Cadiz 70 mm / 1050 x 595 cm - Wand A

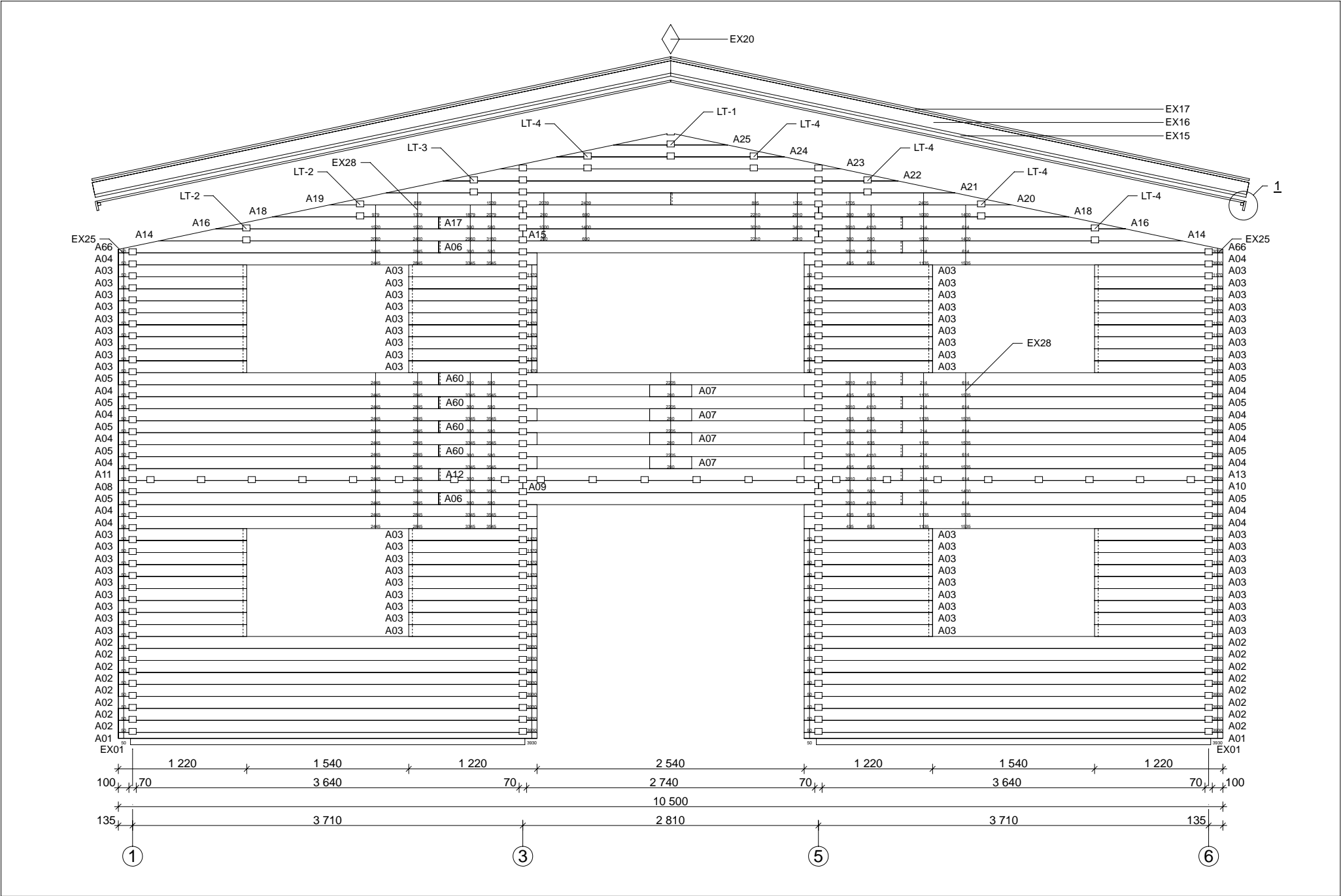



# Cadiz 70 mm / 1050 x 595 cm - Wand B

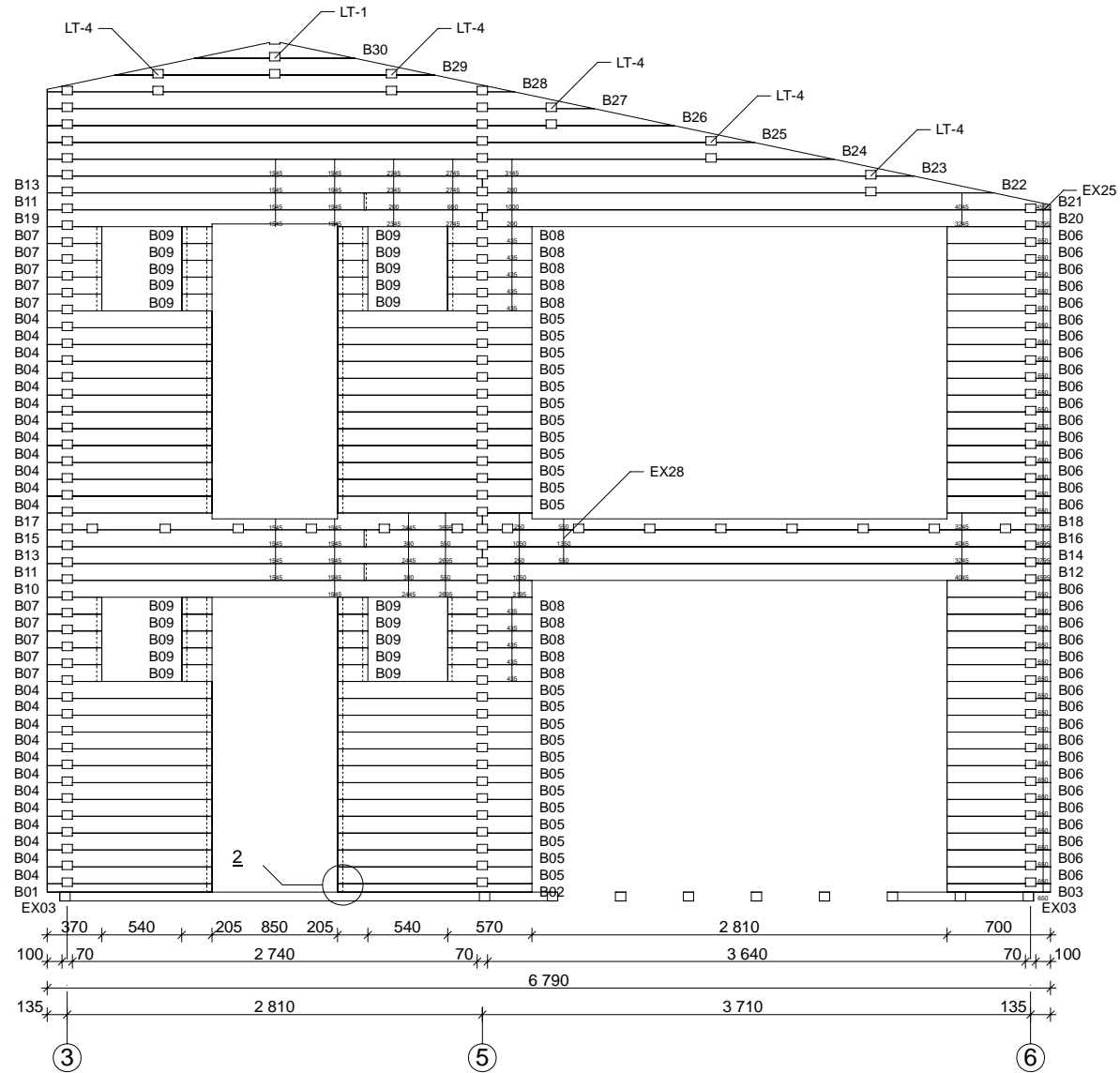

# Cadiz 70 mm / 1050 x 595 cm - Wand C

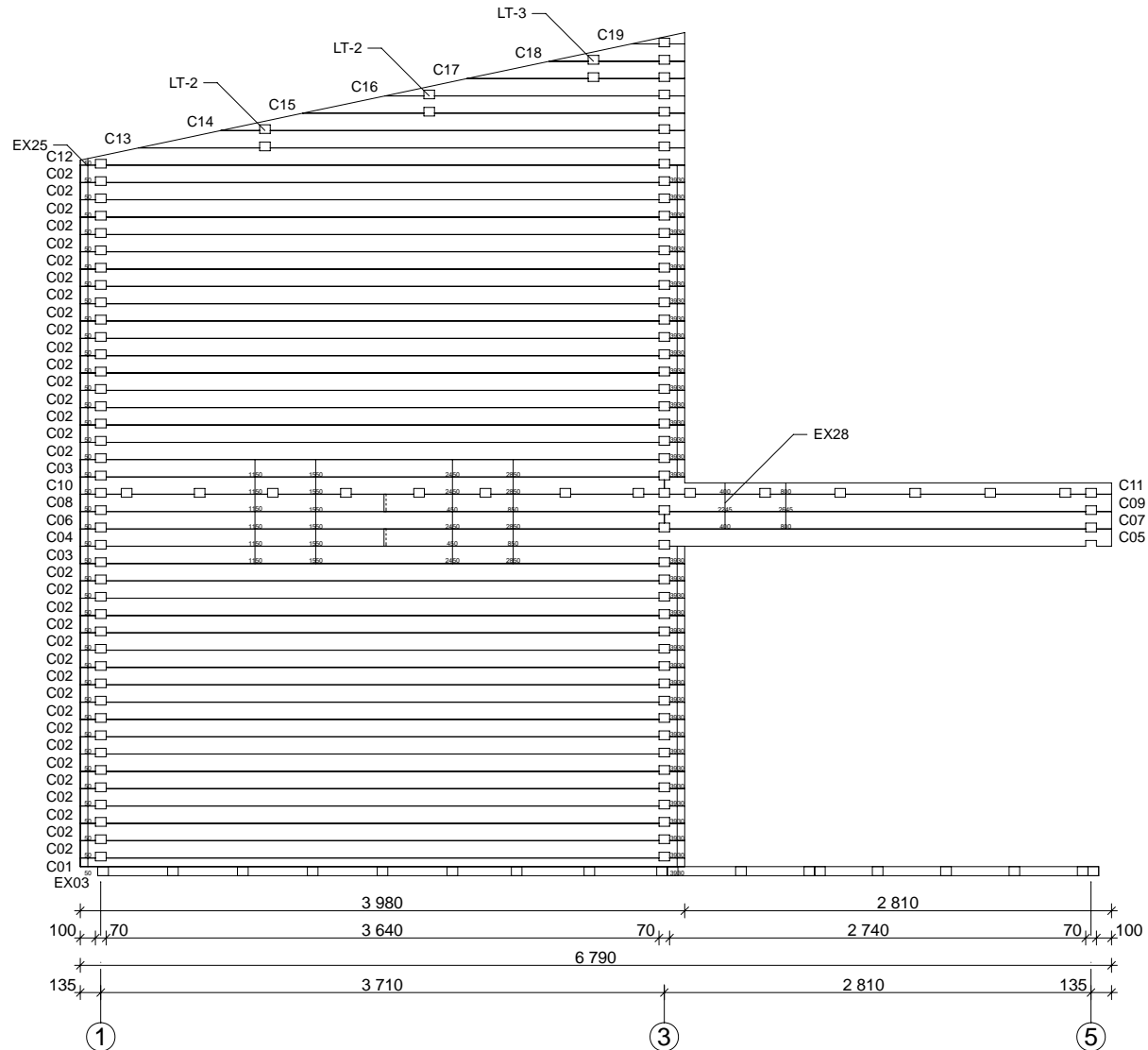

# Cadiz 70 mm / 1050 x 595 cm - Wand D

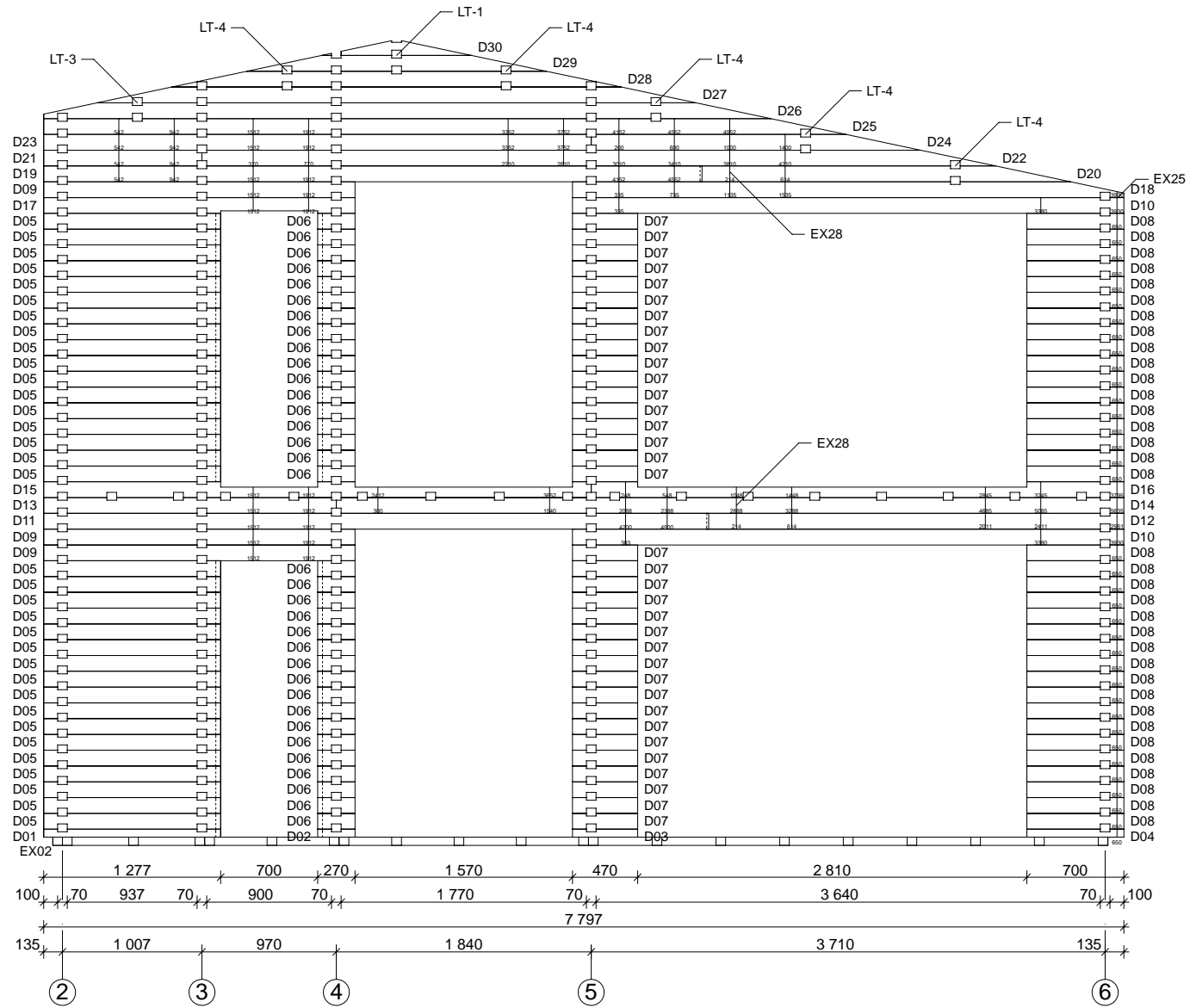

# Cadiz 70 mm / 1050 x 595 cm - Wand E

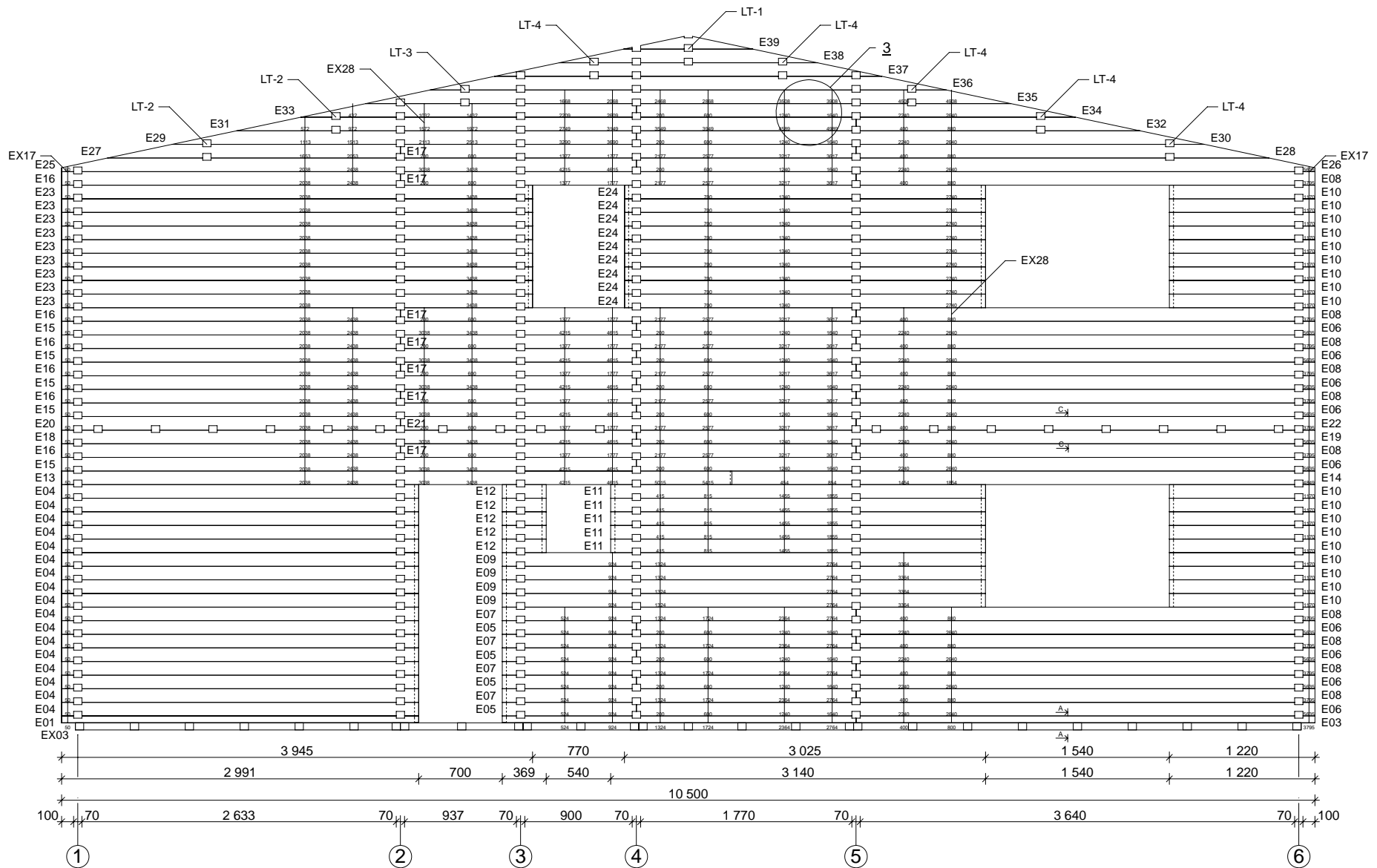

# Cadiz 70 mm / 1050 x 595 cm - Wand 1; Wand 2

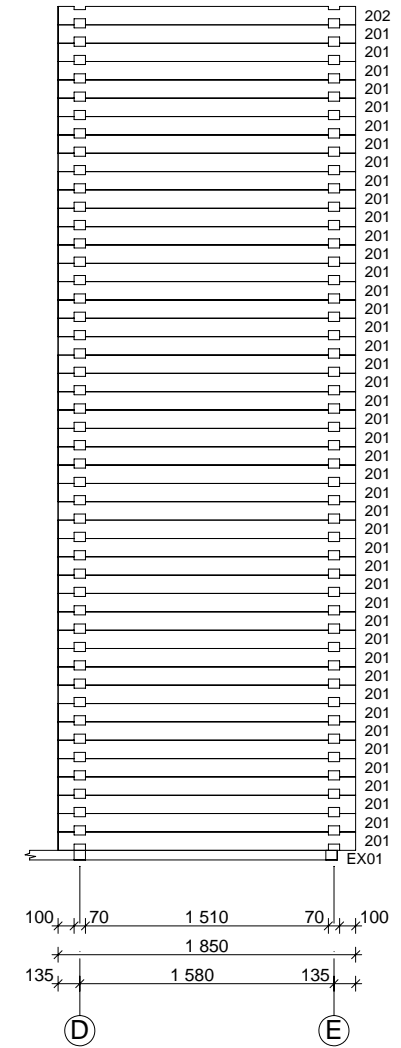
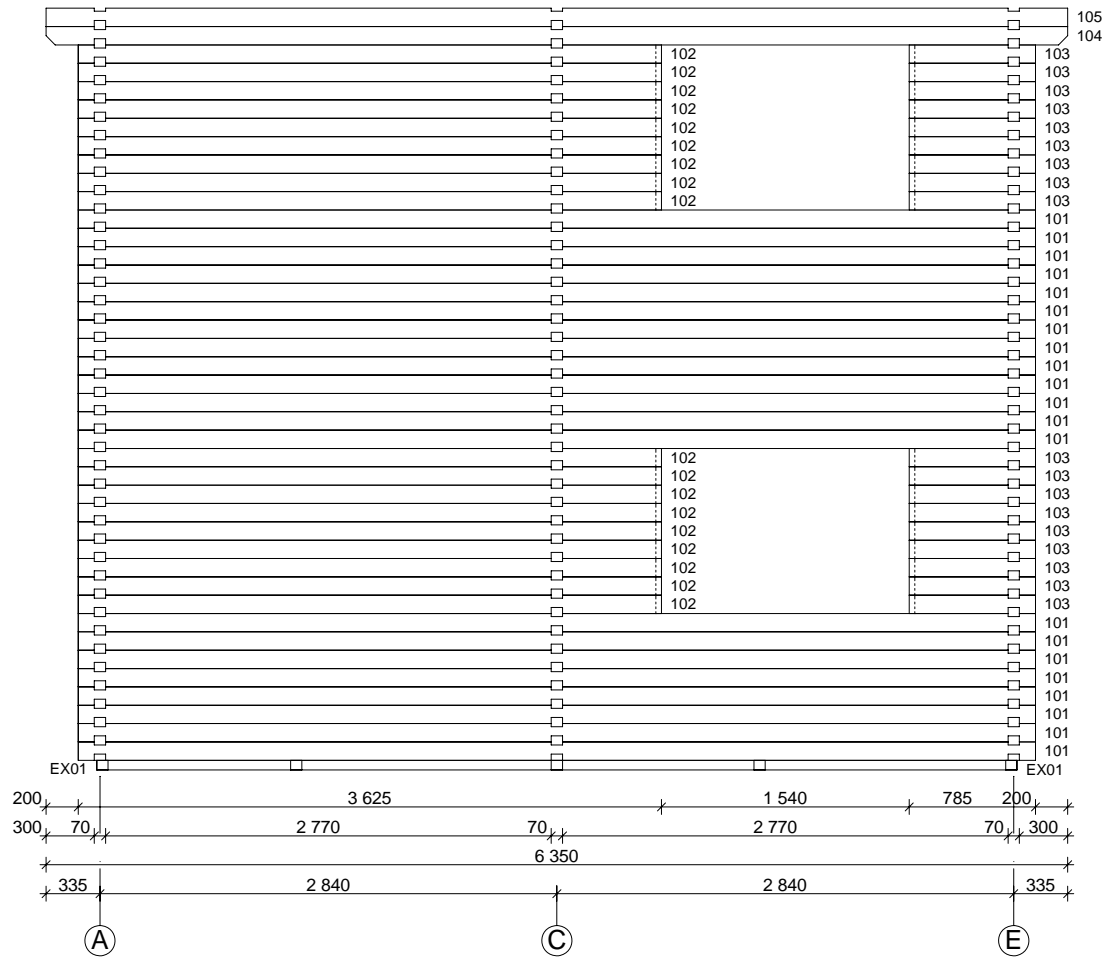

# Cadiz 70 mm / 1050 x 595 cm - Wand 3; Wand 4

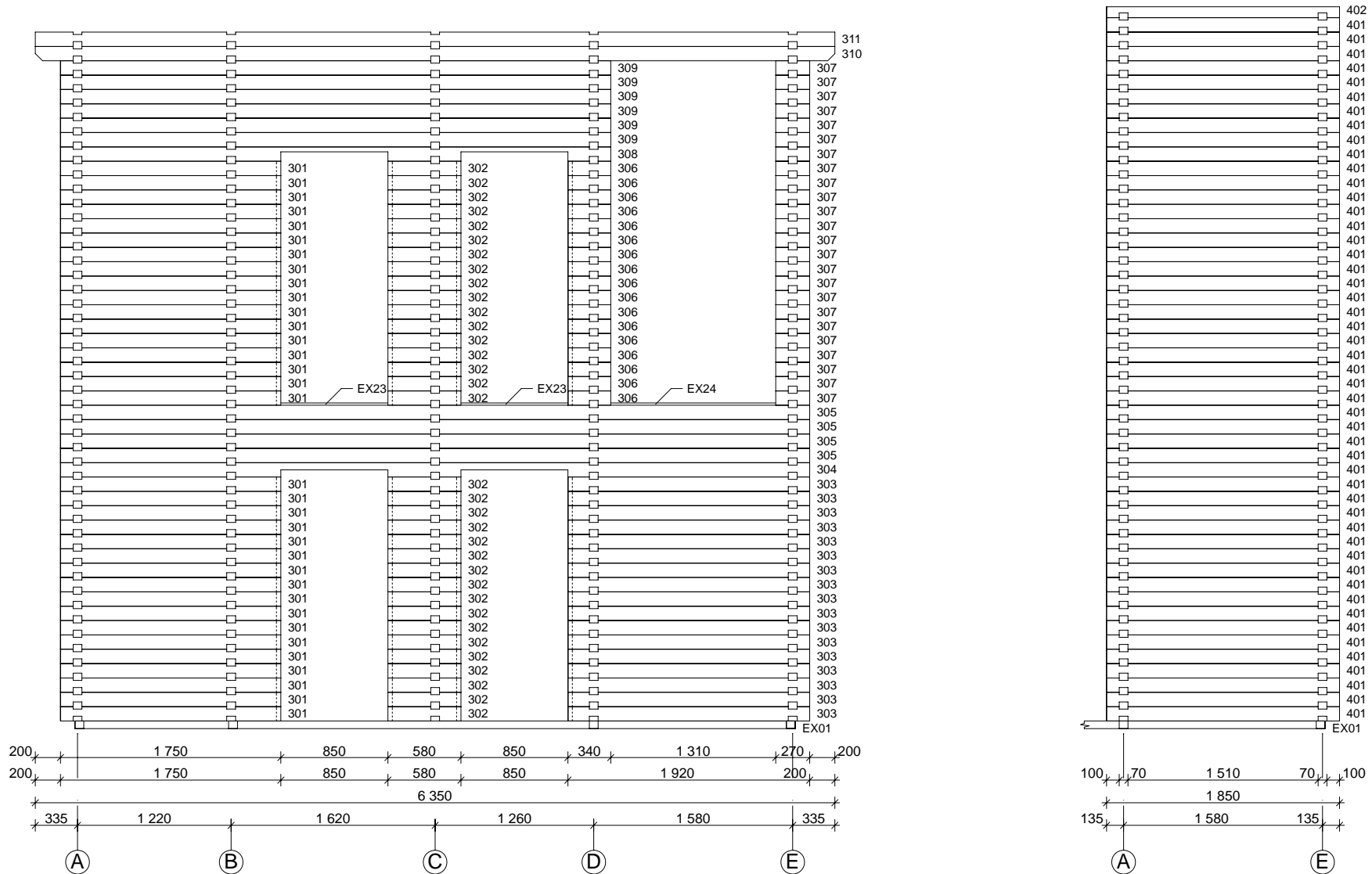

# Cadiz 70 mm / 1050 x 595 cm - Wand 5

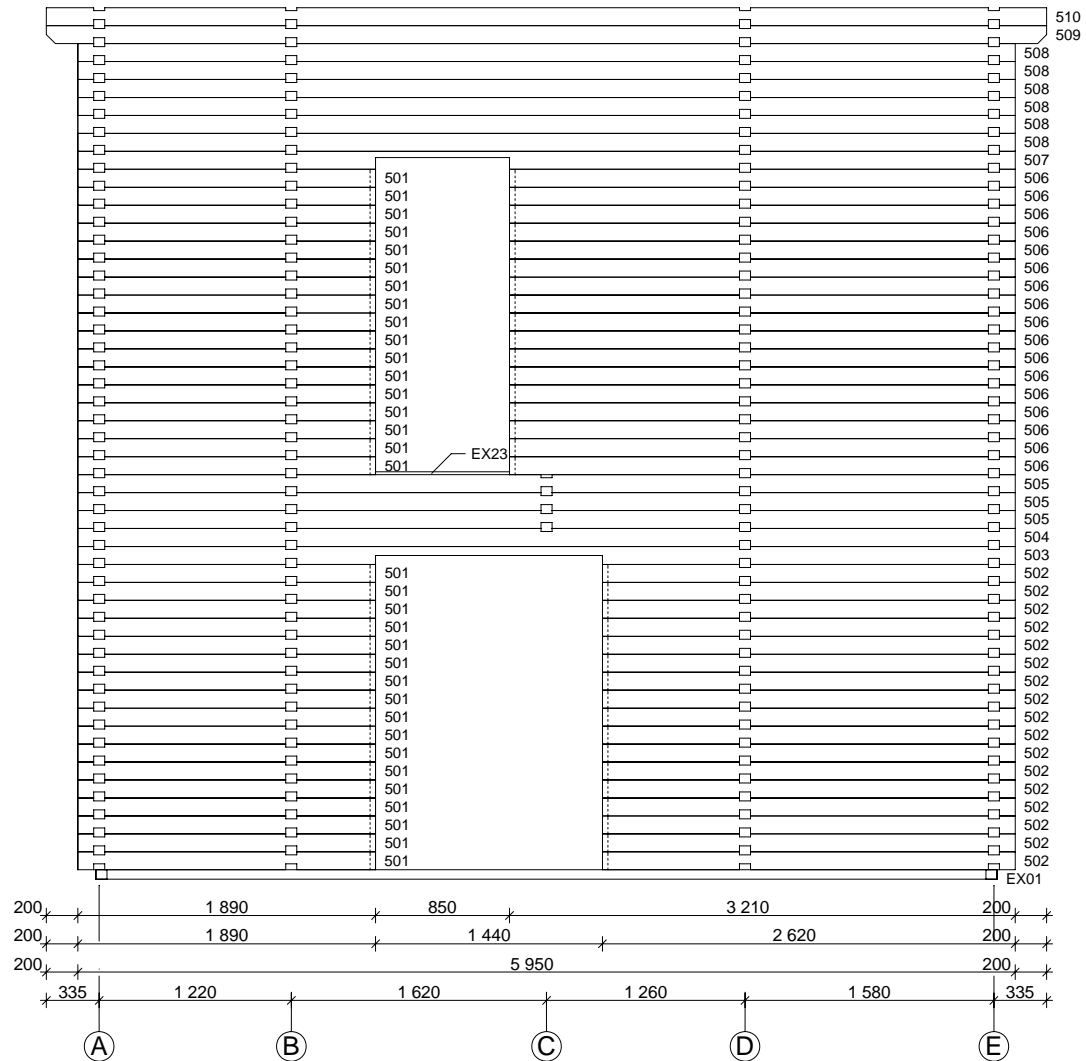

# Cadiz 70 mm / 1050 x 595 cm - Wand 6

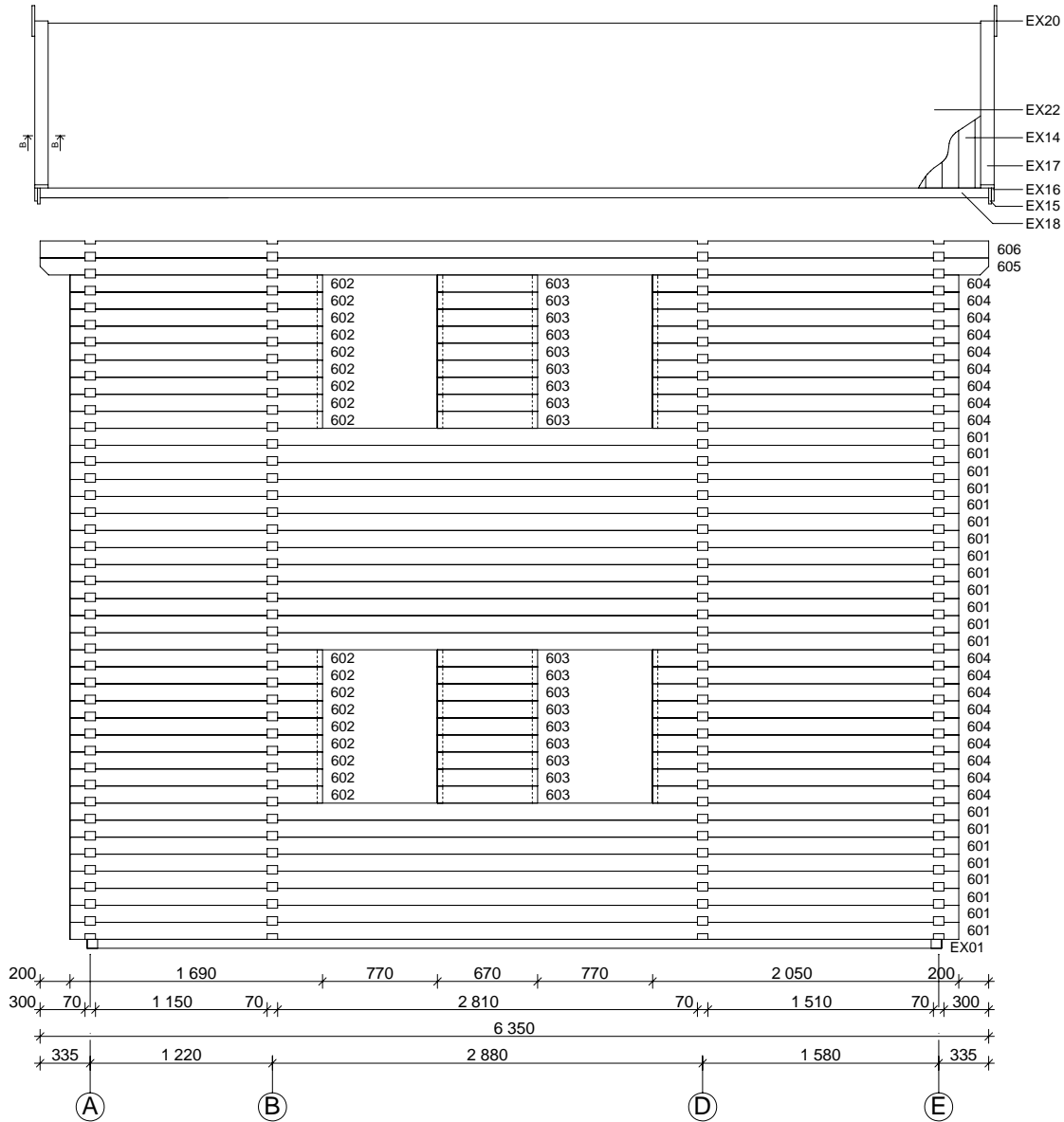



# Cadiz 70 mm / 1050 x 595 cm - Dachbalken; Zwischenbalken

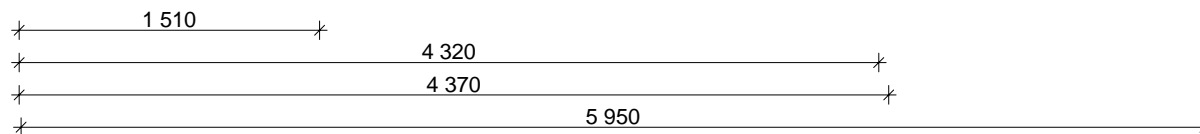
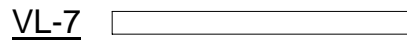
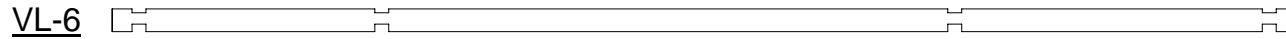
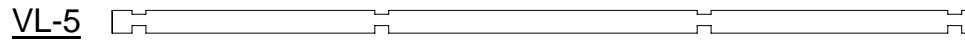
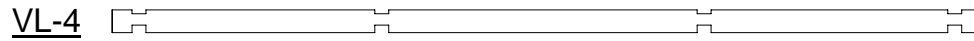
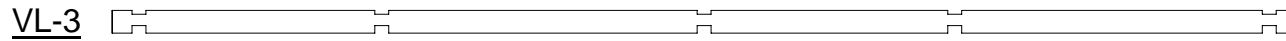
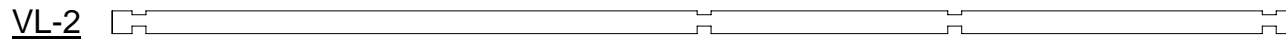
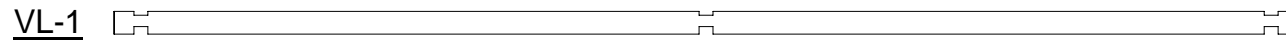
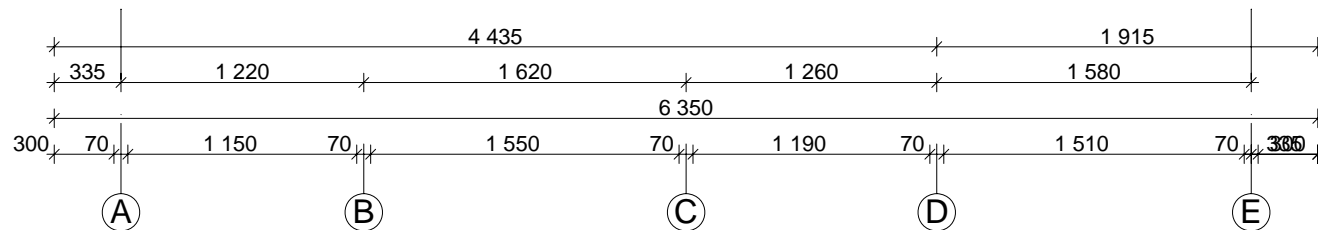
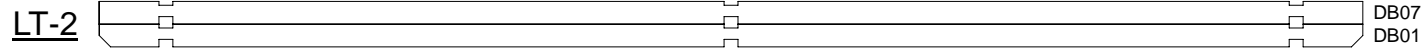
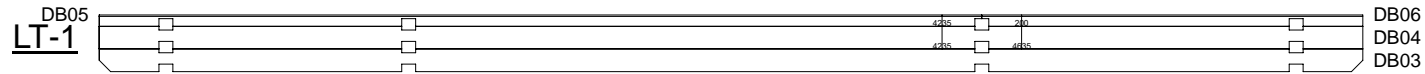

# Cadiz 70 mm / 1050 x 595 cm

1

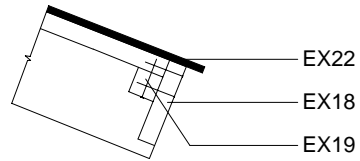

3

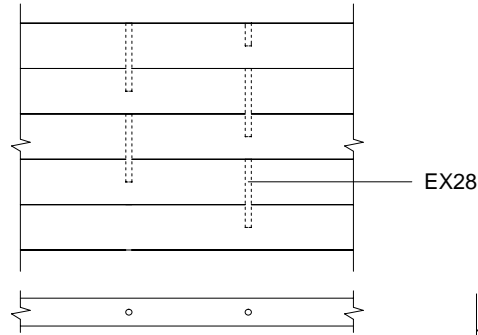

2

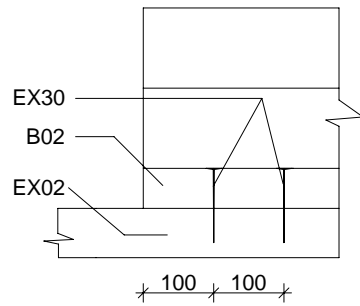

4

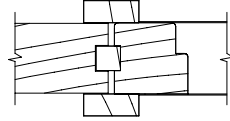

4

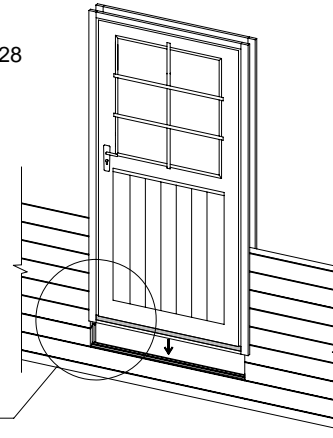

A-A

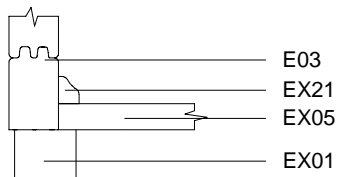

B-B

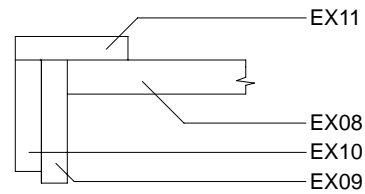

C-C

